

CEREC MAINTENANCE SCHEDULE

Before every wet machining process	WEEKLY	MONTHLY	ANNUALLY
Ensure that the water and Dentatec solution completely covers the filter(s) in the water tank.	Change water in water tank and add 75ml Dentatec.	<ol style="list-style-type: none"> 1. Replace water filter. 2. Check & clean water jets to ensure that water is striking the tools during wet machining. 3. Clean manual block clamp inside the block shaft. 	Call Abacus to book Annual maintenance: 0333 023 0400

WEEKLY WATER CHANGE

At least once a week or when prompted by the system (usually after 240 mins of wet machining time).

1. Drain water, rinse, & repeat until the water runs clear.
2. Add **75ml Dentatec** to the tank. (150ml if using Dentsply Sirona CEREC **Tessera** blocks).
3. Fill the tank with **RO water** (unless local water is soft) until the filter(s) is/are completely immersed (up to the bottom edge of the filler thread, approx. 3 litres).

If you think the filter(s) need cleaning when changing the water or when the "water pressure too low" message appears, **do not remove the filter** as this can weaken the paper causing tears. Half fill the tank with warm water and slosh to agitate. Drain, rinse and repeat until the water runs clear.

Change the filter(s) immediately if damaged; otherwise, monthly as advised above.

Clean the motor water jets if they do not strike the machining instruments by carefully removing any foreign particles from the water nozzles with a cleaning wire or probe. This will help to extend the life of the instruments.

USEFUL PART NUMBERS

Consumables:	Qty:	Part no:
Step Bur 12	(6 pcs)	6260 025
Step Bur 12 S	(6 pcs)	6240 167
Step Bur 20	(6 pcs)	6259 597
Cylinder Bur 12 EF	(6 pcs)	6535 186
Cylinder Pointed Bur 12 S	(6 pcs)	6240 159
Cylinder Pointed Bur 12 EF	(6 pcs)	6535 178
Cylinder Pointed Bur 20	(6 pcs)	6259 589
Shaper 25	(3 pcs)	6299 395
Shaper 25 RZ	(3 pcs)	6433 440
Finisher 10	(3 pcs)	6299 387
Grease Unisilkon LCA 3801	(7g tube)	6501 261
Maintenance parts:		
Dentatec	1000ml	5809 640
Filter for Primemill / MC X / MC TOP-LOADING	(1 pcs)	6387 067
	(6 pcs)	6429 950
Filter for MC X / MC XL SIDE-LOADING	(1 pcs)	6129 519
	(6 pcs)	6129 402
MC Care Liquid	250ml	6631 191

MONTHLY FILTER REPLACEMENT

Replace water filter monthly or as needed depending on usage (change filter after approx. 40 mills).

1. Add **MC Care Liquid** as indicated on cap measure, direct to the mill chamber.
2. Manually run water pump for 5-10 minutes.
3. Remove water tank, drain the water, and re-insert water tank.
4. Run the pump again until all of the water is out of the system for approx. 30 secs.
5. Remove tank, drain plug and drain into sink. Replace tank drain plug.
6. Remove filler cap with **tank cap opener (tool 6280171)** and half fill with warm tap water. Replace filler cap and slosh. Remove tank drain plug and drain again. Repeat until water runs clear and no ceramic residue left in the tank. A brush can be used to remove stubborn ceramic deposits – advise removing filter, drain, and filler cap and submerging in a suitable sink e.g. Decontamination room.
7. Remove filter(s) with **tool 6280171** and discard paper filter. Filter insert (metal spring or grey plastic tube) and plastic filter cap.
8. **NEW FILTER(S)**
Add a small amount of grease (if available) **GREASE UNISILKON - LCA 3801 (6501261)** to internal hole of filter, threads, and black o-ring.
9. Insert new filter and tighten firmly by hand. **Do NOT use tool, over-tightening can damage the tank.**
10. Ensure drain plug is inserted, measure 75ml of Dentatec and pour directly into tank.
11. Fill with **RO water** (unless local water is soft) to bottom of filler opening.
12. Replace tank and run water pump to remove air from the system prior to milling. Check water level in tank and top up if necessary.
13. The unit is now ready to use.

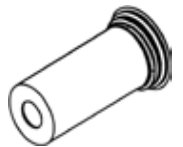

CALL 0333 023 0400
FOR ASSISTANCE OR TO ORDER PARTS
or email support@countonabacus.co.uk